

SCHULTE®

RDX-102 **AVALANCHE**

Snow Blower



Rotating Drum
on RDX-102

Rotation angles of 25° to left,
through center chute or 52° to right

- 1** 102" wide cut and efficient twin stage design are ideally suited to 85-140 HP tractors.
- 2** The RDX-102 rotating drum allows snow to be ejected out left or right side or through center chute.
- 3** In heavy wet snow, blowing capacity of the RDX-102 is greatly increased due to the fact the snow can be discharged directly off the fan paddles versus all the way up through the center chute.
- 4** Highly efficient 30" - four paddle fan with an open center and cupped blades results in improved throwing distance on all models.
- 5** A heavily reinforced auger feeds snow to the fan and ensures that chunks of ice and hard packed snow are broken up before being discharged.
- 6** A replaceable cutting blade and replaceable adjustable skid shoes are standard on all models.
- 7** A heavy duty gearbox with 1 5/8" splined shafts provides positive power delivery to the fan.
- 8** UHMW bearing and bronze bushings in the rollers allow for reduced freeze-up on chute.
- 9** Shear bolt protection for the fan and cross auger.
- 10** Enclosed chain case protects the drive chain from debris.

G O N U M B E R O N E . . . G O S C H U L T E !

Features

A Patent pending drum rotation cylinder (2.5" x 20") rotates fan housing to eject snow out the left or right side or through the center chute.

(Circular arrows show cylinder movement)

New adjustable replaceable skid shoes allows cutting blade to follow ground more closely.



SCHULTE RDX-102

The RDX-102 includes a heavy duty 300 degree gear driven chute rotation mechanism that is operated by a 7.3 cubic inch hydraulic motor. (No more cables!!) High carbon steel is used in both the cutting edge and adjustable skid shoes. A heavy duty shaft is standard on the RDX-102. A standard Category 2 three point hitch or Category 2 quick hitch can be used to attach to the blowers. New rotating drum design with a bearing in the front and the rear of the drum. Front bearing uses UHMW and the rear bearing uses Nylatron. The two bearings ensure proper rotation of drum and prevent skewing. The new RDX-102 drum uses a cylinder for rotation. This cylinder ensures your drum is held firmly in place during operation and does not "Creep" out of position.

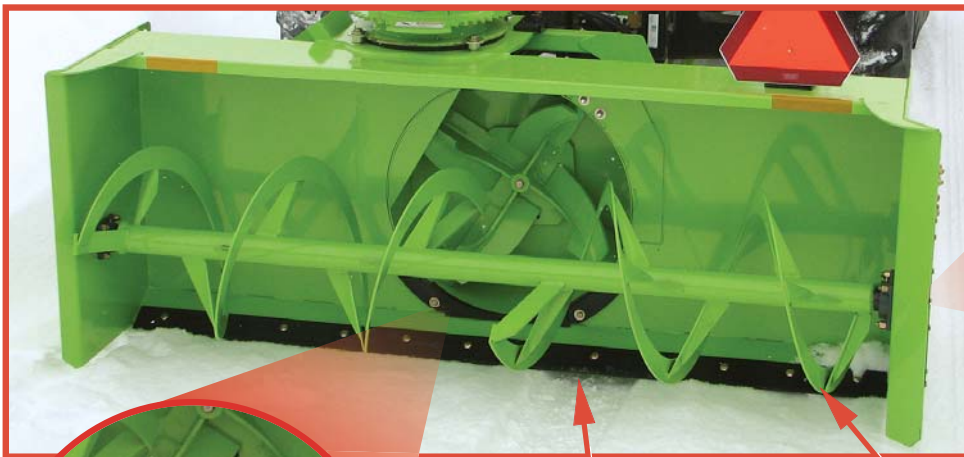

Replaceable cutting blade

23" open auger

The RDX-102 drum is made of Hardox 450 which has a hardness of 450 BHN or 48 Rockwell C. This drum is very hard and is very resistant to abrasion from rocks, gravel and other debris. It will provide a long and trouble free service life.

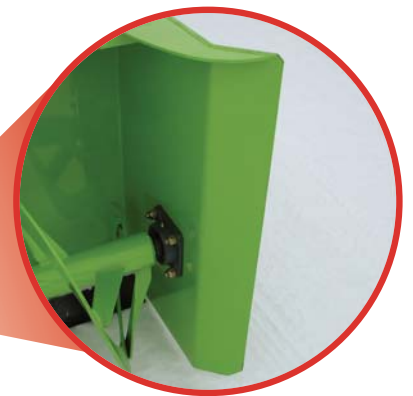

Enclosed Chain Case with easy access from the side (bolted on cover) or from the top (flip shield). The enclosed chain case puts an end to the sprockets and chain from running in the snow, ice and debris. This will increase the overall life of the chain and sprockets.

Features

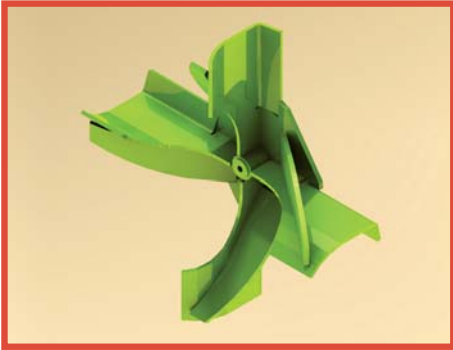

The heart of this Snow Blower is the 4 paddle open center, cupped blade design fan that concentrates snow to the center & back of the fan resulting in improved performance.



A 23" open auger design with formed struts includes more braces in the center for increased strength and durability. This type of design cuts into hard packed snow & feeds the fan with ease.



The double chute deflector with a standard 2" x 6" cylinder reduces blow back considerably in comparison to single deflectors.



A gear driven 300 degree hydraulic chute rotator comes standard with a 7.3 cubic inch hydraulic motor.



High grade steel bolt in replaceable cutting blade is standard and gives many years of trouble free cutting performance.

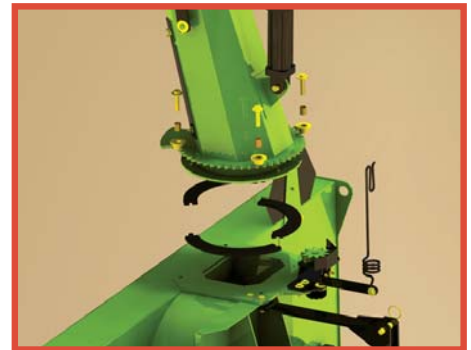

A high molecular UHMW bearing area keeps freeze ups to a minimum in the coldest weather conditions.



Adjustable replaceable skid shoes are standard. Gauge wheel with tapered roller bearings are optional for use on pavement or cement.



1 5/8" splined and heat treated fan shaft is standard on the RDX-102. A 1 5/8" splined hub welded into the fan ensures maximum strength over competitive keyed designs.

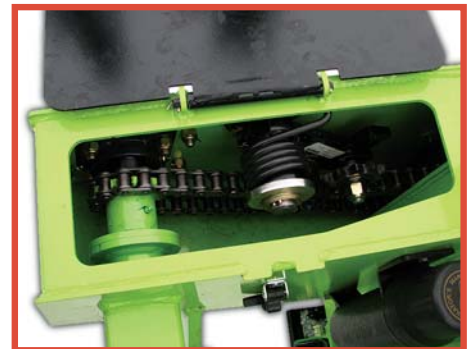

Enclosed chain case with spring tension tightener for idler sprocket maintains constant tension on the auger drive chain and reduces chain wear and possible freeze ups.

RDX-102 Series Specifications

SPECIFICATIONS

Cutting Width	102" (2.6m)
Tractor Horsepower	85 - 140 HP (63 - 104KW)
Cutting Height	37" (939mm)
Overall Height	100" (2.54m)
Auger Diameter	23" (584mm)
Fan Diameter	30" (762mm)
Fan Type	4 paddle
Fan Shaft Diameter	1 5/8" (41mm)
Auger Drive Chain	#80
Weight	2050lbs (930kg)
Adjust. Double Linked Chute Deflector	Standard
Hydraulic Chute Rotation Mechanism	Standard
Replaceable Blade	Standard
Adjustable Replaceable Skid Shoes	Standard
Hitch Size	Cat II, Cat II quick hitch
PTO Speed	540 RPM
Capacity - Dry snow / Wet Snow	426tons/hr / 1343tons/hr



Side eject - left side



Side eject - right side

RDX-102 OPTIONS

1. Heavy duty power shaft - size 8
2. Heavy duty chute kit with cylinder kit
3. Truck loading chute kit with cylinder kit
4. Gauge wheel kit



A perfect combination for Schulte's RDX-102 is the FM-300 front mount 3pt hitch frame.

SPECIFICATIONS

FM-300

Tractor horsepower, maximum	250 HP
Tractor PTO (1000 rpm preferred)	1000 RPM for SDX-117, RDX-102 & SDX-960 540 RPM for SDX-960 and RDX-102
Lift capacity	5000 lbs
Adjustability	Accommodates tractors between 151" and 211" measured from front mount plate to drawbar pin
Nominal ground clearance	13" depending on tractor installation
Nominal lift range	18"
Weight	1650 lbs



Schulte Industries Ltd.,

P.O. Box 70, Englefeld, Saskatchewan, Canada S0K 1N0

Tel: (306) 287-3715 Fax: (306) 287-3355

E-Mail: info@schulte.ca

Visit our Web site at: www.schulte.ca

Schulte is a registered trademark of Alamo Group Inc.

Schulte Industries Ltd. reserves the right to change the design, specification of its products without notice. Illustrations may include optional equipment and accessories, and may not include all standard equipment.



ISO 9001

Sold By:

PRINTED IN CANADA

PREPARED by NELSON GRAPHIC DESIGN

201105